



GEARGRID Mini Mobile Bottle / Hose Storage System

Assembly Instructions & Owner's Manual

Thank you for choosing the GearGrid Mini Mobile Bottle / Hose Storage System. GearGrid is committed to high-quality products and your complete satisfaction.

Please read this manual before you start the assembly. Call us at 888-643-6694 if you need technical assistance or encounter product performance questions along the way.

Before You Begin:

NOTE: Two person assembly is required

Assembly Preparation:

- Open and remove contents from all boxes
- Check all parts against the parts list
- Organize parts by type
- Locate a clear, level floor
- Lay the shipping carton cardboard on the floor and assemble the unit on it for protection during assembly.

Tools Required:

- Rubber mallet
- 3/8" and 7/16" sockets with ratchet
- 1/8" Hex Allen wrench



THANK YOU FOR CHOOSING GEARGRID for smarter, stronger, storage solutions.
Setting the standard for craftsmanship, quality and service.

For general parts or assembly assistance: 651-464-4468 or toll free 888-643-6694

For accessory inquiries: sales@geargrid.com or 651-464-4468, toll free 888-643-6694

For our versatile product line, specifications and resources for custom solutions: www.geargridcorp.com

670 SW 15th Street, Forest Lake, MN 55025 | Toll Free: 888-643-6694 | 651-464-4468 | Fax: 651-464-4780
sales@GearGrid.com | www.geargridcorp.com

Parts

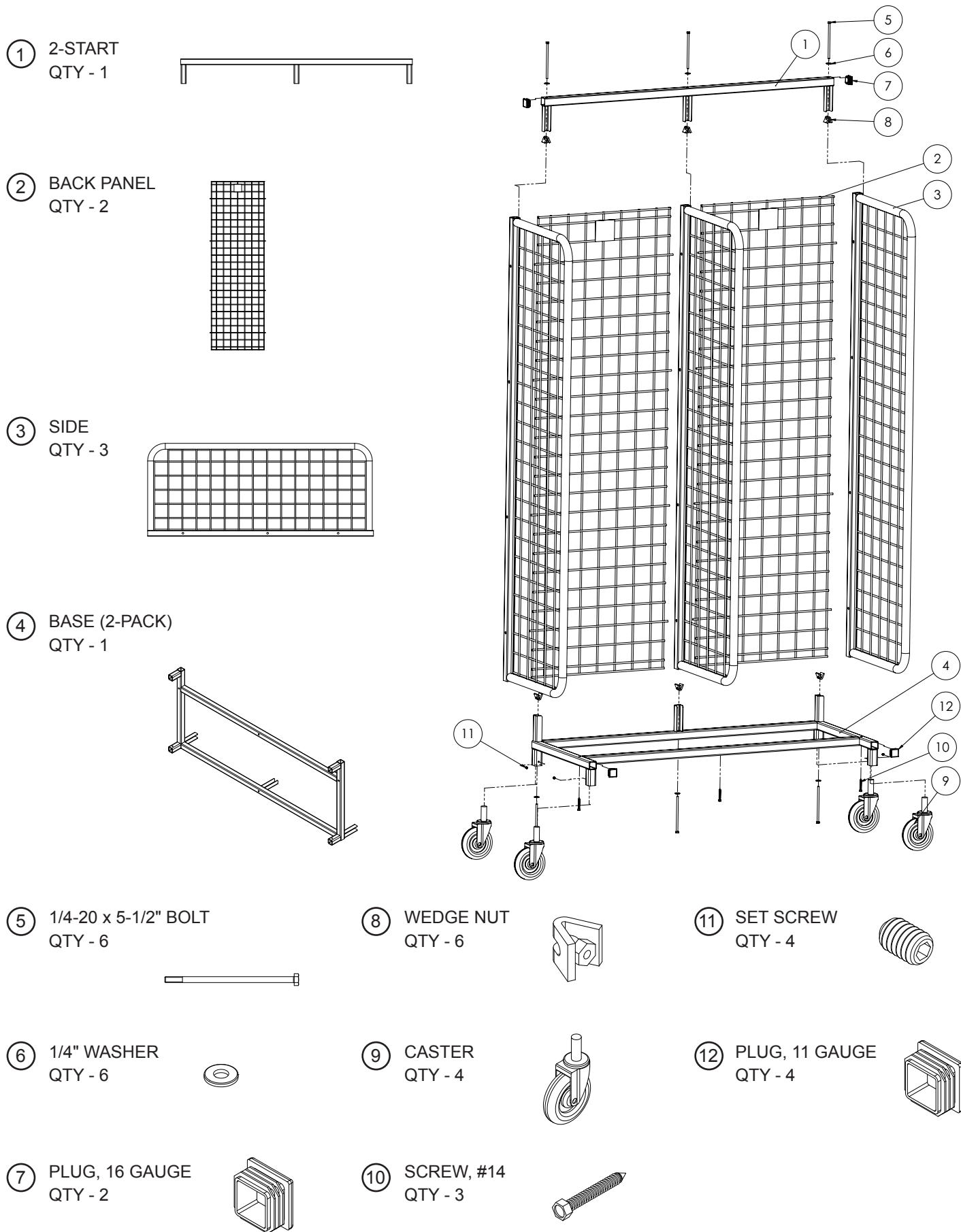

Base Unit Assembly

Assemble 2-Start

Step 1: Locate the following parts from the list:

Part	Description	Quantity
#1	2-Start	1
#5	1/4-20 x 5 1/2" Bolt	3
#6	Washer	3
#8	Wedge Nut	3

Install the bolt through the top of the 2-start with the washer on top. Thread the bolt into the wedge nut. ENSURE THE WEDGE NUT IS IN THE ORIENTATION AS SHOWN IN THE PHOTO BELOW. **Do not tighten bolts at this point.**



Assemble Base

Step 2: Locate the following parts from the list:

Part	Description	Quantity
#4	Base	1
#5	1/4-20 x 5 1/2" Bolt	3
#6	Washer	3
#8	Wedge Nut	3

Position the base on its side with the 3 U-Channels on the floor and install the bolts, washers and wedge nuts as described in the previous step. **Do not tighten bolts at this point.**

Assemble Side Panels to Base

Step 3: Locate the following parts from the list:

Part	Description	Quantity
#3	Side	3

Position a side panel so the hole on the bottom of the round tube is located at the base. Slide the side panel over the U-Channel as shown in the photos below. Do not slide the side panel all the way down on the base at this point. Install the remaining side panels per the instructions above.

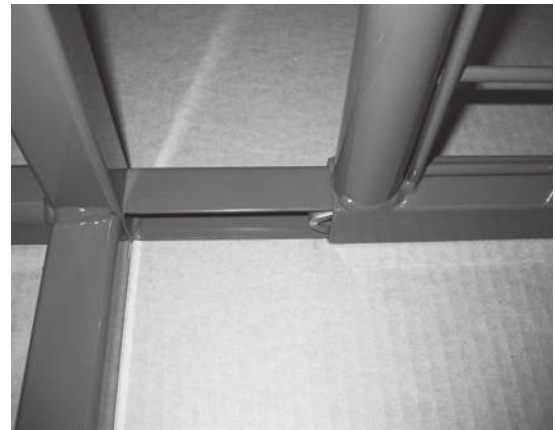

Base Unit Assembly (cont.)

Install Back Panels

Step 4: Locate the following parts from the list:

Part	Description	Quantity
#2	Back Panel	2

Spread sides apart enough to allow the installation of the back panels as shown in the photo below. The extended wires on the panels will mate into the holes on the side tubes. Place both panels into position.

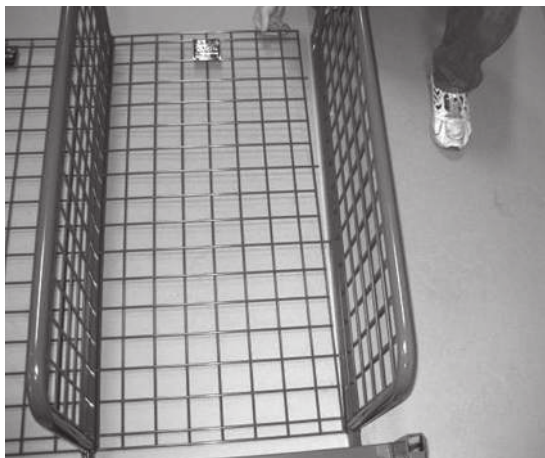

Install 2-Start

Step 5: Locate the following parts from the list:

Part	Description	Quantity
#1	2-Start with installed hardware	1

Take the 2-Start with the installed hardware and place it into the top of the sides as shown in the photo below. Push the bottom and top of the unit together and torque all of the bolts (qty-6). **Do not over tighten because the tubing wall will start to deform.**



Fasten Side Panels to Base

Step 6: Locate the following parts from the list:

Part	Description	Quantity
#10	Sheet Metal Screw	3

Install one sheet metal screw through the bottom of the base into the hole located on the bottom of each side panel. There's 1 for each side panel as shown in the photo below.

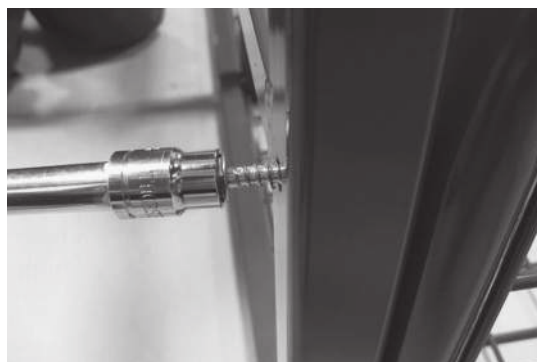

Install Casters

Step 7: Locate the following parts from the list:

Part	Description	Quantity
#9	Caster	4
#11	Set Screw	4

Install casters into the base legs and tighten in the set screws with the casters fully seated as shown in the photos below.

(Note: the set screw holes on the base are located on the back sides of the legs.)



Base Unit Assembly (cont.)

Install Plugs

Step 8: Locate the following parts from the list:

Part	Description	Quantity
#7	Plug, 16 gauge	2
#12	Plug, 11 gauge	4

Install two 16-gauge plugs into the 2-Start ends to cap the tubes. Install four 11 gauge plugs into the base to cap the tubes.

With two people flip the unit up on its casters, it is now ready for shelves.

Shelf Parts List

⑬ SCBA SHELF
QTY - PER ORDER

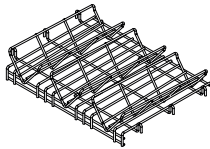

⑭ BRACKET, L.H.
QTY - 1

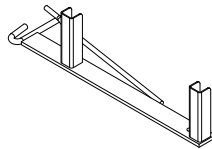

⑮ BRACKET, R.H.
QTY - 1

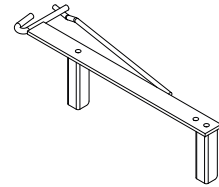

⑯ J-HOOK
QTY - 2

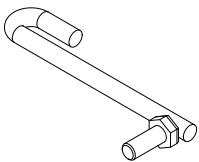

⑰ SHELF TUBE
QTY - 2

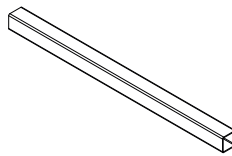

⑱ 1/4-20 x 4-1/2" BOLT
QTY - 4

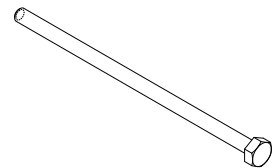

⑲ 1/4" WASHER
QTY - 4

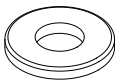

⑳ WEDGE NUT
QTY - 4

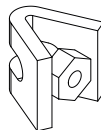

㉑ BOOK END
QTY - PER ORDER

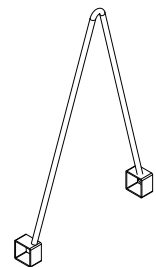

㉒ 5/16-18 NYLOCK NUT
QTY - 2

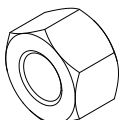

Shelf Installation

Bottle Shelf Installation

Step 1: Locate the following parts from the list:

Part	Description	Quantity
#13	Bottle Shelf	per order

Install the shelf into unit as shown in the photos below. The hooks on the shelves get placed over the horizontal wires on the side panels. The left-side hook will be placed behind the first vertical side panel wire. The right-side shelf hook will be placed in front of the first vertical wire.



Hose Shelf Assembly

Step 1: Locate the following parts from the list:

Part	Description	Quantity
#18	1/4-20 x 4 1/2" Bolt	4
#19	1/4" Flat Washer	4
#20	Wedge Nut	4
#14	Bracket, L.H.	1
#15	Bracket, R.H.	1

Install bolt through the washer and through the outside of the side bracket. Place the wedge nut inside the U-Channel and thread the bolt in. Do this step for both sides, as shown in the photo below. Ensure the orientation of wedge nut is as shown. **Do not tighten bolts at this point.**

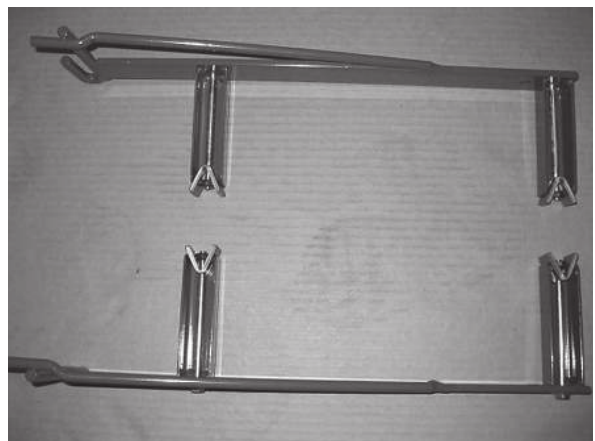

Shelf Installation (cont.)

Hose Shelf Assembly

Step 2: Locate the following parts from the list:

Part	Description	Quantity
#21	Book End	1
#17	Shelf Tube	2

Slide shelf tubes over the U-Channels on one side of the bracket as shown in the photos below. Next, slide the book end over the shelf tubes with the book end angled in towards the center. Then, install the other bracket side over the other end of the shelf tubes. Push the hose shelf together and tighten the bolts. **Do not over tighten because deformation of the material will occur.**

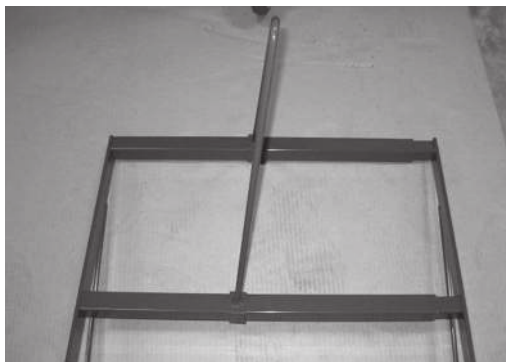
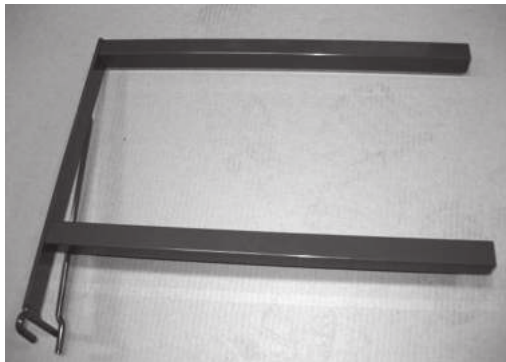

Hose Shelf Installation

Step 1: Locate the following parts from the list:

Part	Description	Quantity
#16	J-Hook	2
#22	Nylock Nut	2

Install assembled hose shelf by hooking it to the back panel on the unit. Take one J-Hook and a nylock nut and fasten shelf to side panel as shown in the photos below. Install the second J-Hook the same way on the other side of the shelf.

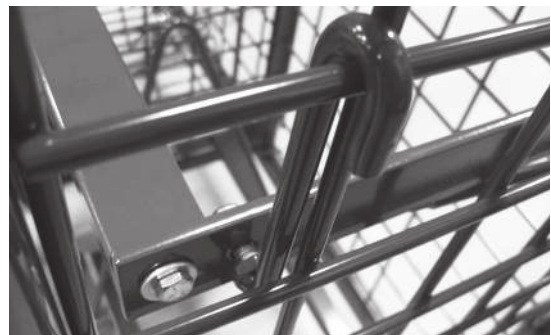

Warranty

GEARGRID Wall Mount Lockers are guaranteed to be free of material and workmanship defects for one full year from the date of purchase.

GEARGRID guarantees to repair or replace defective materials, without charge. To file a claim call our Customer Service department at 888-643-6694. If product return is necessary your Customer Service representative will authorize the return and make arrangements to replace the defective parts.

This is your sole GEARGRID warranty. GEARGRID disclaims all other warranties, including the warranty of merchantability and fitness for a particular purpose, as well as all liability for incidental, consequential, special and indirect damage. GEARGRID liability shall be limited to the amount you paid for the product under warranty. GEARGRID reserves the right to make product changes without obligation to incorporate such changes into products previously sold.

Some states do not allow the exclusion or limitation of damages or warranties, so the above may not apply to you. This warranty gives you specific legal rights. You may also have other rights which may vary from state to state.

GEARGRID products are covered by U.S. patents: 6,241,107; D 636,202; D 635,810



670 SW 15th Street | Forest Lake, MN 55025
Phone: 888-643-6694 | 651-464-4468
Fax: 651-464-4780

